

CORTE A - A

Escala 1:75

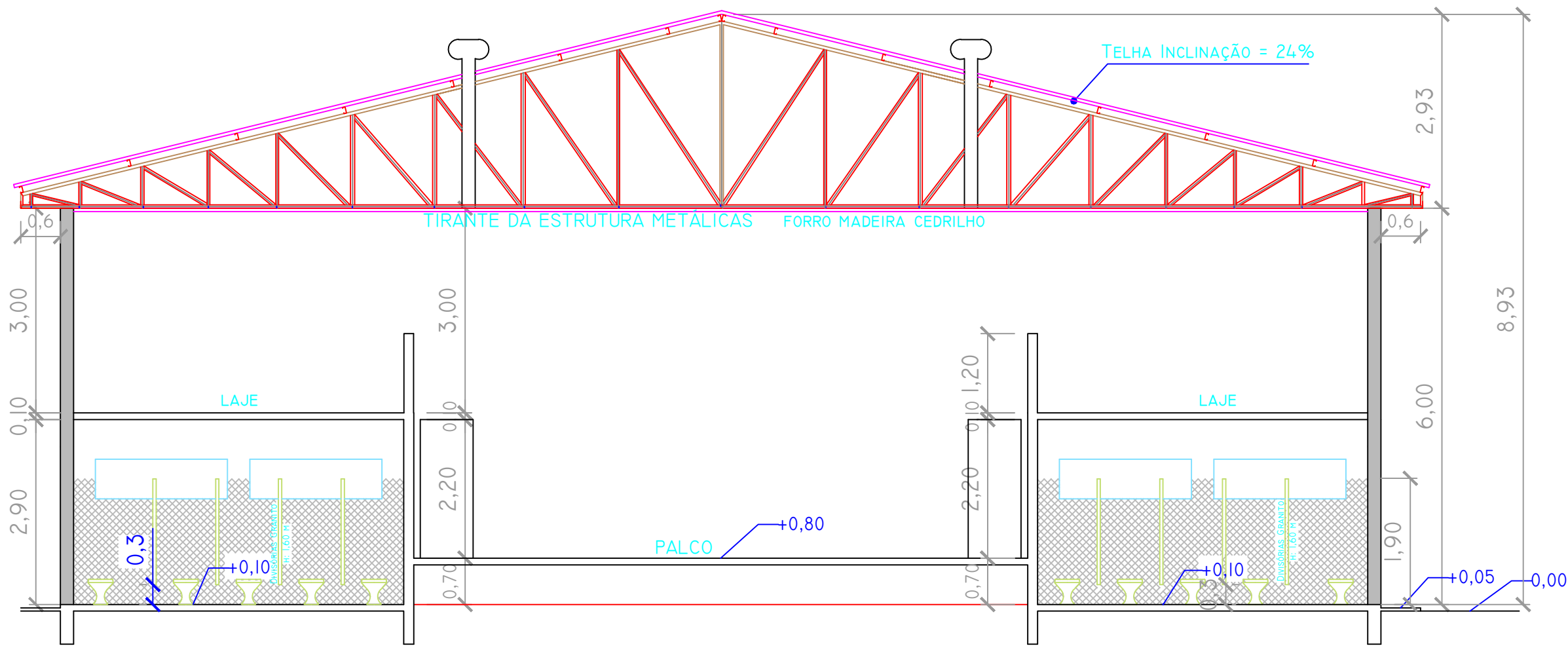

CORTE B - B

Escala 1:75

PERFIL DO TERRENO

ESCALA 1/1750

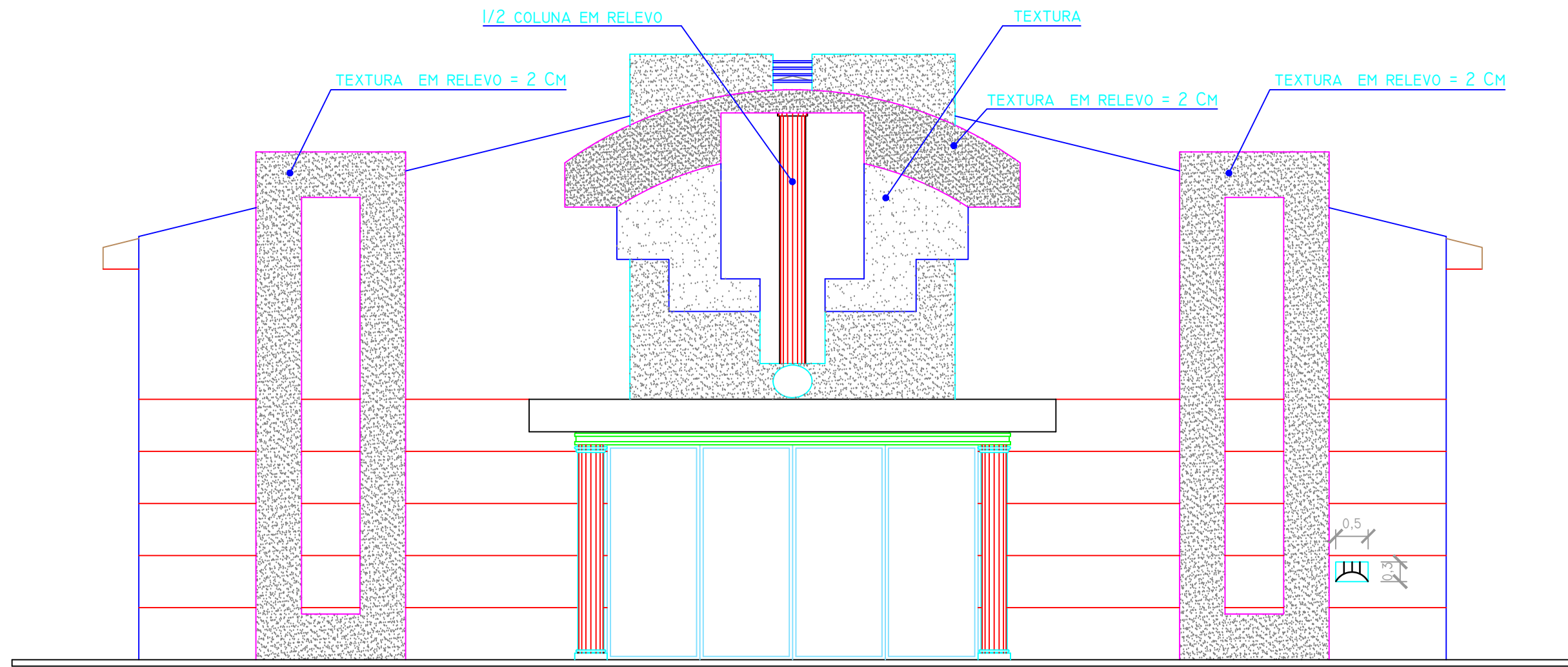
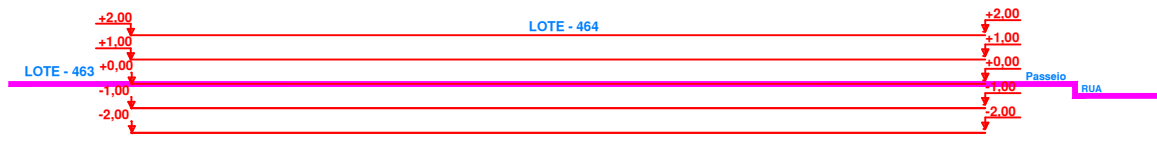
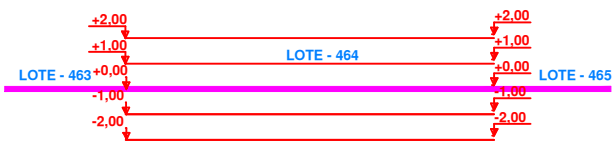

FACHADA FRONTAL

Escala 1:100

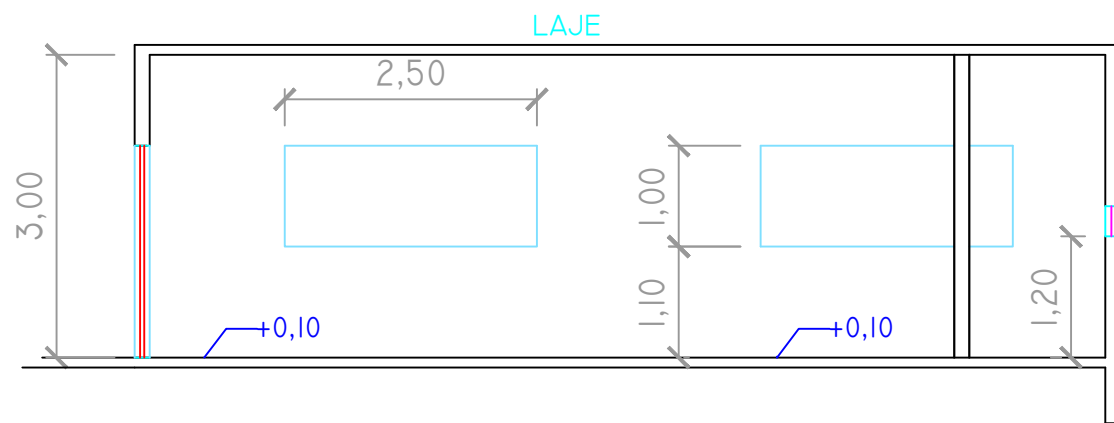

CORTE C - C

Escala 1:75

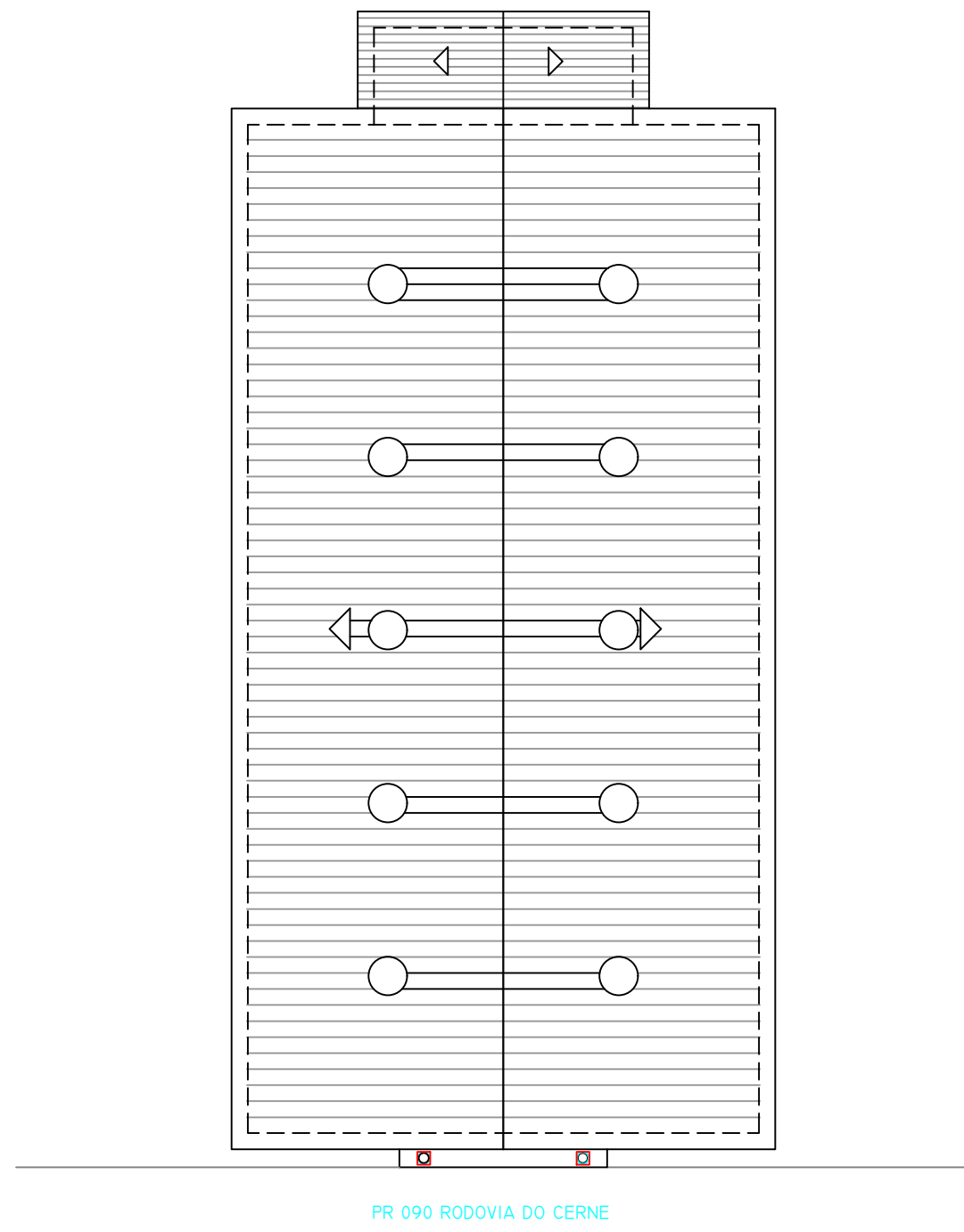

COBERTURA

Escala 1:200

APROVAÇÃO:

PROJETO ARQUITETÔNICO

FOLHA

02/03

SALÃO DE EVENTOS VENTANIA PR.
PR - 090, km 195 + 350 m



PROPRIETÁRIO: PREFEITURA MUNICIPAL DE VENTANIA PR
ADM. PREF. OCIMAR ROBERTO BAHNERT DE CAMARGO
VENTANIA PR

ESCALA

INDICADA
DATA: ABRIL 2011
DESENHO: JEFFERSON PHILLIPI

RESP. TÉCNICO
Eng. CIVIL JEDO JOSÉ STIMAMIGLIO
CREA PR-14315/D

OCIMAR ROBERTO BAHNERT DE CAMARGO
PREFEITO MUNICIPAL